

Hartford Landfill: Its Future

A Community Input Meeting

April 12, 2006

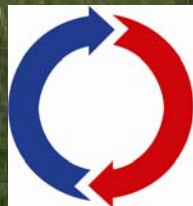

**CONNECTICUT
RESOURCES
RECOVERY
AUTHORITY**

Welcome

- CRRA:
 - Thomas D. Kirk, President
 - Peter W. Egan, Director of Environmental Affairs & Development
 - Paul Nonnenmacher, Director of Public Affairs
 - David Bodendorf, PE, Senior Environmental Engineer
- Fuss & O'Neill:
 - Richard D. Jones, PE, Senior Vice President
 - Craig M. Lapinski, PE, Project Manager
- Johnson Land Design:
 - Dean A. Johnson, FASLO, LLA, FAAR



Agenda

- Purpose of Meeting
- Hartford Landfill: An Overview
- Closure of the Landfill
- Future Use of the Landfill



Purpose of Meeting

- Discuss CRRA's closure plan
- Solicit community input on future use of the landfill



Purpose of Meeting

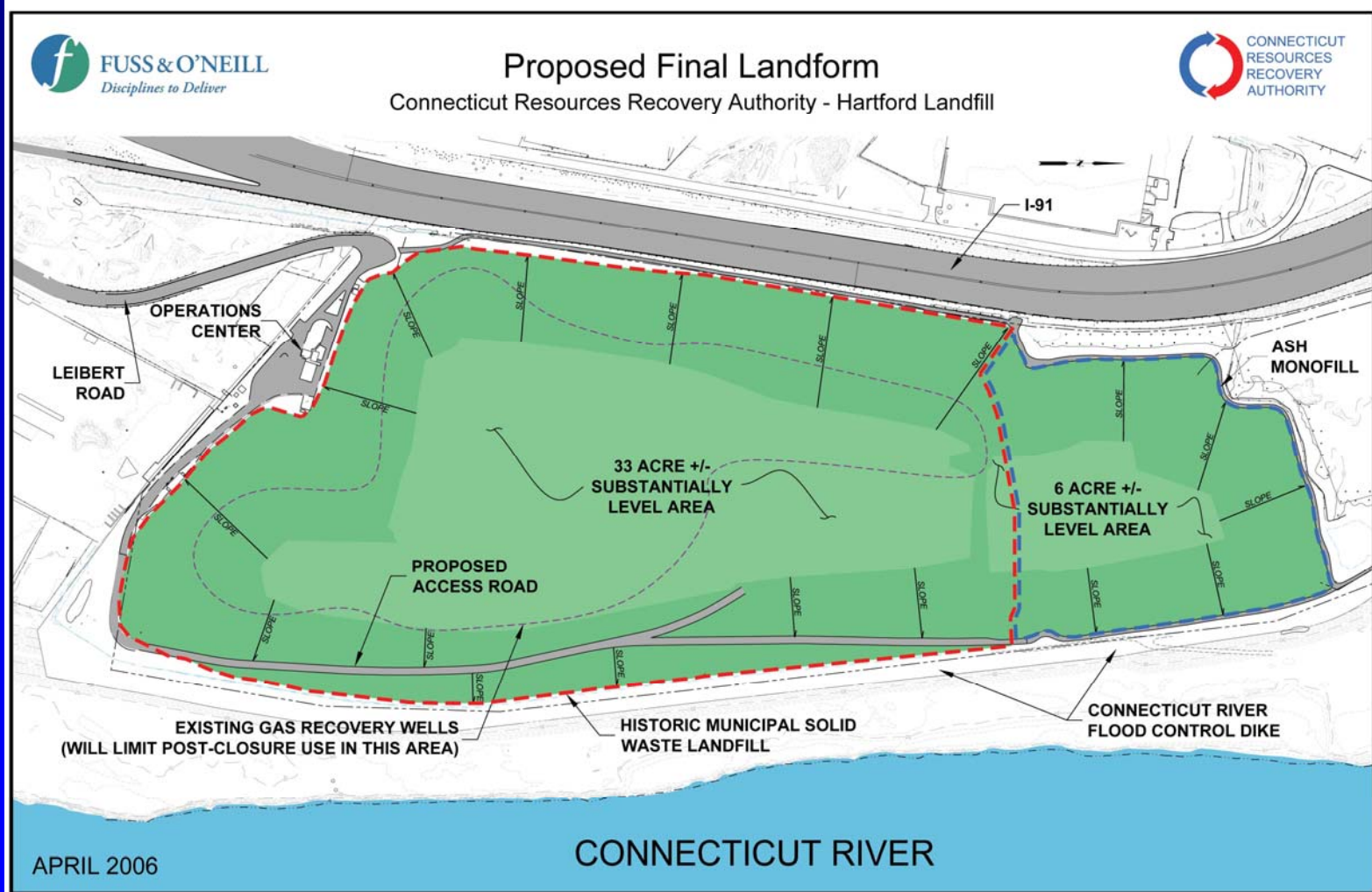

Hartford Landfill
Future Use Meeting

April 12, 2006



Hartford Landfill: An Overview

- History of the landfill
 - Used by city since 1940s
 - CRRA leased from city in 1982
 - Landfill still owned by City of Hartford



Hartford Landfill: An Overview

- The landfill today



Hartford Landfill: An Overview

- Environmental safeguards
 - Groundwater flow control system
 - Ash-leachate collection system
 - Groundwater monitoring program
 - Landfill gas collection & control system
 - Systems to function for decades after closure



Hartford Landfill: An Overview

- Lease agreement with City
 - PILOT to city
 - Other payments to city
 - Total CRRA payments to city: \$5,500,000/year



Closure of the Landfill

- CRRA decision to close in 2008
- Board decided not to seek expansion
 - Decision based in part on community input
 - Potential design capacity to 190 feet
 - Existing elevation 138 feet



Closure of the Landfill

- DEP requirements for closure plan
 - Existing permit & regulatory requirements
 - Simple low-permeability clay cap
 - Reduces infiltration of rainwater
 - Topsoil & seed



Closure of the Landfill

- Proposed closure plan
 - Enhanced synthetic cap instead of clay cap
 - State of the art
 - 90% less rainwater infiltration
 - Uniform 3:1 slope around entire landform
 - Date certain for closure
 - Final delivery on or before Dec. 31, 2008
 - Conceptual discussion of potential future uses



Closure of the Landfill



Geomembrane Cap Design Alternatives Connecticut Resources Recovery Authority - Hartford Landfill

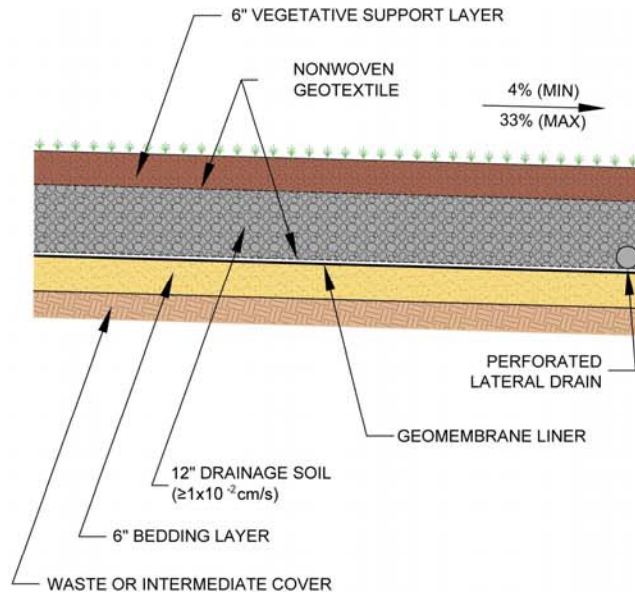

1 GEOMEMBRANE CAP WITH DRAINAGE SOIL
NOT TO SCALE

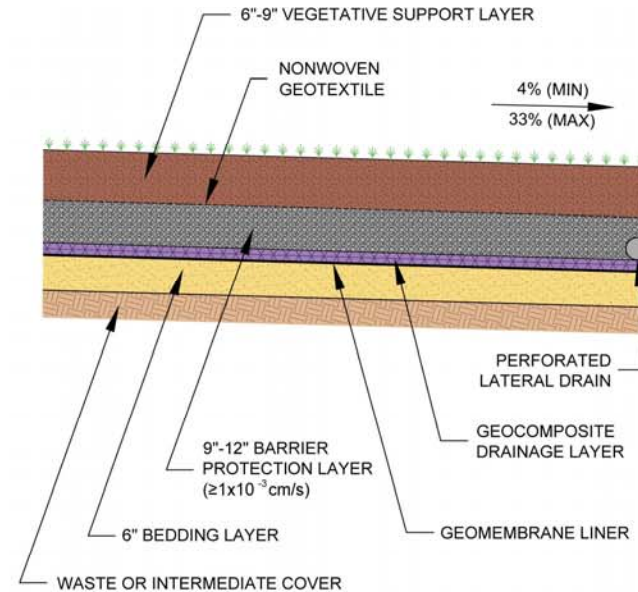

2 GEOMEMBRANE CAP WITH DRAINAGE NET
NOT TO SCALE

APRIL 2006



Closure of the Landfill

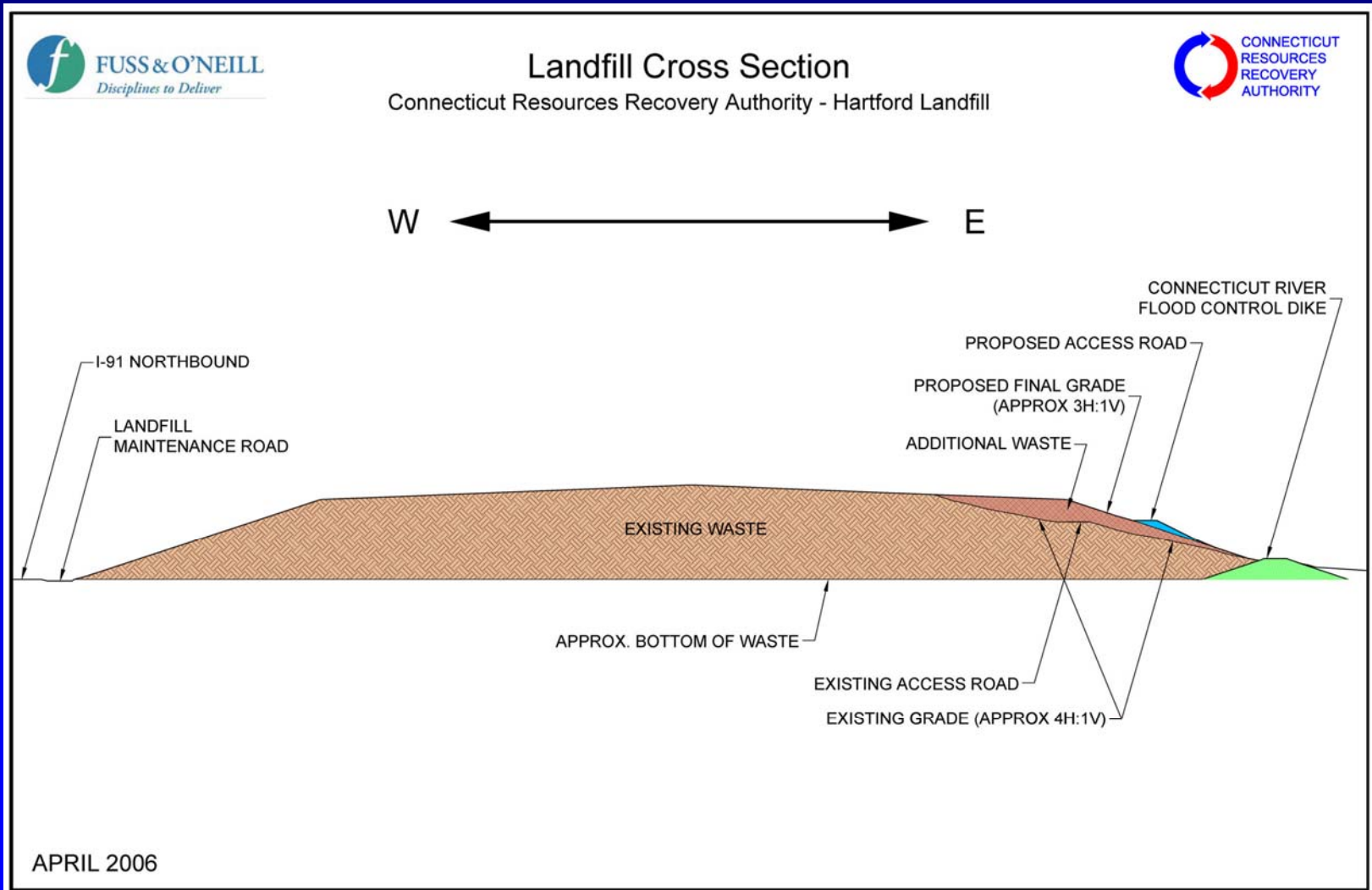

Closure of the Landfill

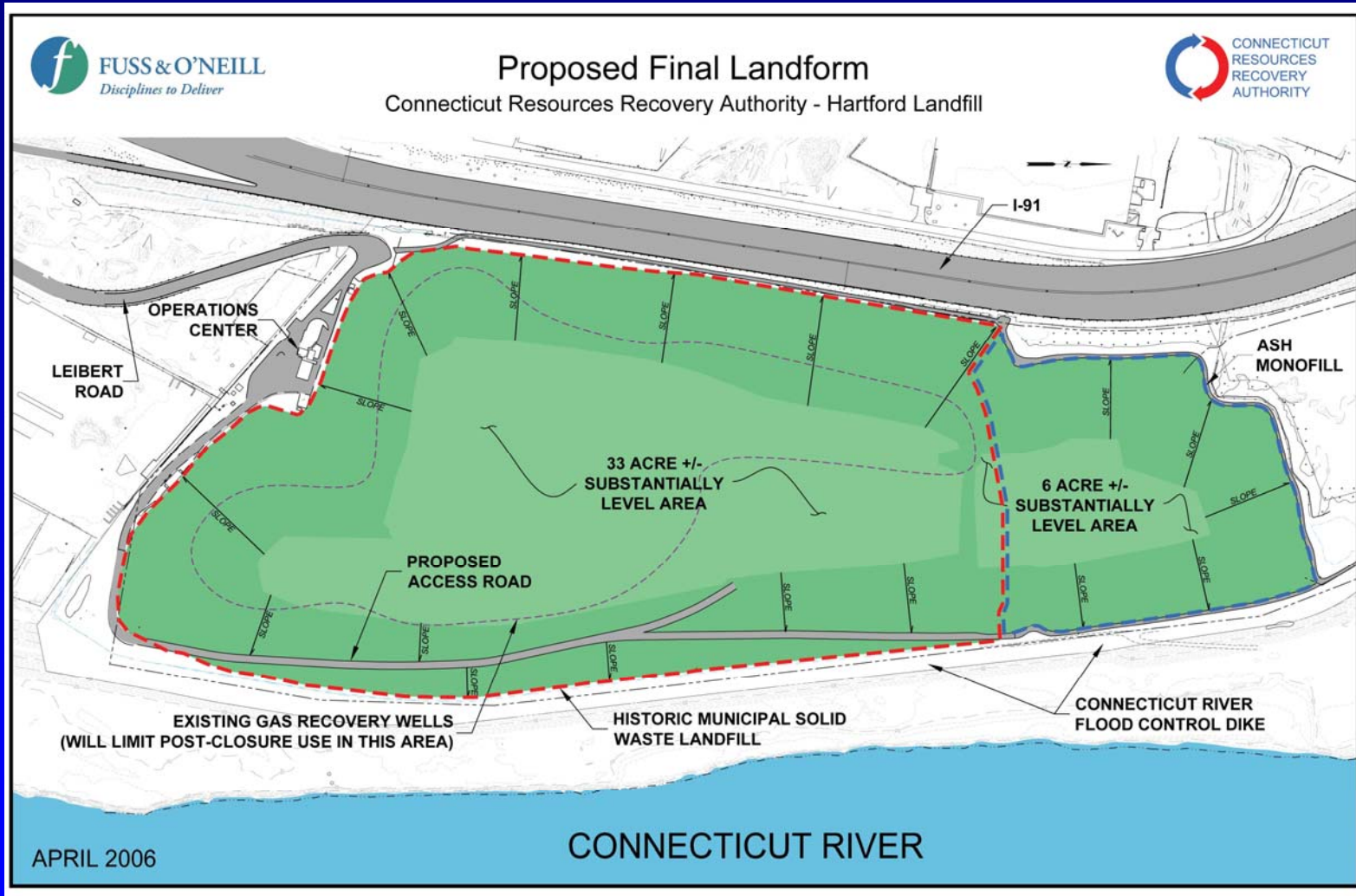

Hartford Landfill
Future Use Meeting

April 12, 2006



Closure of the Landfill



Meriden Landfill

Closure of the Landfill

- Timeline of closure process
 - CRRA submits revised plan to DEP
 - DEP reviews revised plan
 - DEP approves revised plan
 - Closure activities begin on west slope upon plan approval



Future Use of the Landfill

- Post-closure care & maintenance
 - Minimum 30 years
- Gas collection system
- Leachate collection & treatment systems
- Groundwater monitoring
- Land surface care



Future Use of the Landfill



One possibility: development into parkland

Hartford Landfill
Future Use Meeting

April 12, 2006



Future Use of the Landfill

- Walking trails
- Fitness course
- Interpretive signage
- Outlooks – panoramic vistas
 - Hartford
 - Connecticut River
 - Surrounding hills
- Wildlife habitat
- Limitations



Future Use of the Landfill



Future Use of the Landfill



Hart
Future Use Meeting

April 12, 2006



Future Use of the Landfill



Hartford
Future Use Meeting

April 12, 2006



Future Use of the Landfill

- Your comments

