

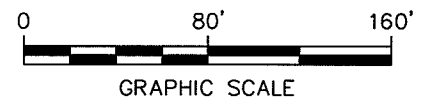

SOURCE:
 BASE MAP FROM TOPOGRAPHIC SURVEY
 TITLED "TOPOGRAPHIC SURVEY, WATERBURY
 LANDFILL, HIGHLAND AVENUE & HIGHLAND
 STREET, WATERBURY, CONNECTICUT,
 PREPARED FOR CONNECTICUT RESOURCE
 RECOVERY AUTHORITY", DRAWING NUMBER:
 26-350TP, SCALE: 1"=20', DATED:
 12-20-06, BY MARTINEZ, COUCH &
 ASSOCIATES, LLC.

- NOTES:**
- 1) PROPERTY BOUNDARY IS APPROXIMATE AS NOTED ON ABOVE REFERENCED TOPOGRAPHIC SURVEY.
 - 2) LOCATION OF PROPERTY WITHIN THE CONNECTICUT STATE PLANE NAD 1927 IS APPROXIMATE AND SHOULD NOT BE CONSIDERED ACCURATE.



	21 Griffin Road North Windsor, CT 06095 (860) 298-9692
	CONNECTICUT RESOURCE RECOVERY AUTHORITY WATERBURY LANDFILL HIGHLAND AVENUE & HIGHVIEW STREET WATERBURY, CONNECTICUT
EXISTING CONDITIONS PLAN	
Date: 04/05/07	Project No. 42798-0140-00000
Dwg: G1	

J:\CAD\42798\0140\Plate-1.dwg, G1 11x17, 4/5/2007 2:11:25 PM, Adobe PDF

J:\CAD\42798\0140\
 Plate-1.dwg Layout:G1 11x17 April 05, 2007-2:11PM KHOLLENBECK

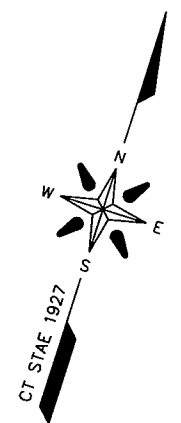
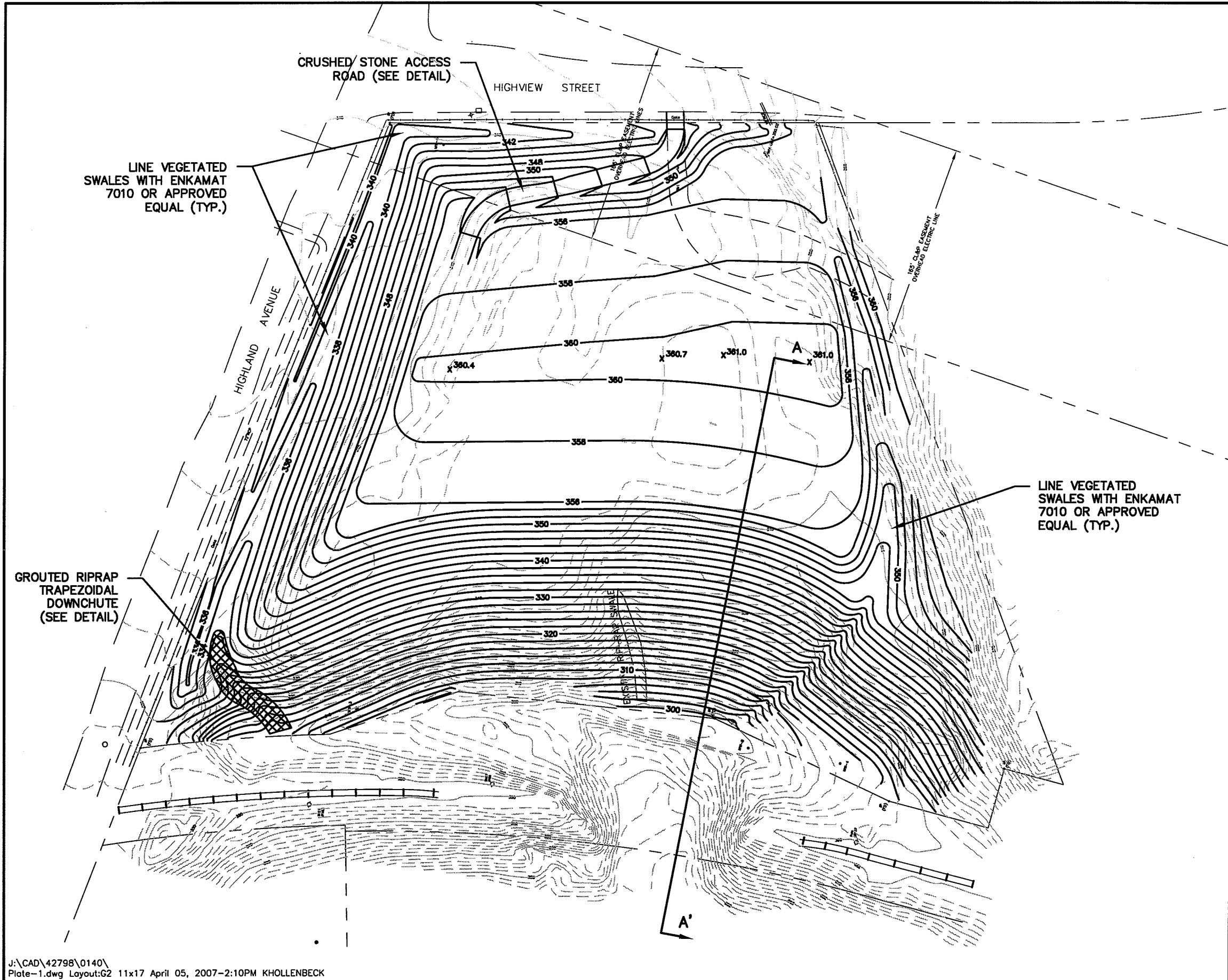

SOURCE:
 BASE MAP FROM TOPOGRAPHIC SURVEY
 TITLED "TOPOGRAPHIC SURVEY, WATERBURY
 LANDFILL, HIGHLAND AVENUE & HIGHLAND
 STREET, WATERBURY, CONNECTICUT,
 PREPARED FOR CONNECTICUT RESOURCE
 RECOVERY AUTHORITY", DRAWING NUMBER:
 26-350TP, SCALE: 1"=20', DATED:
 12-20-06, BY MARTINEZ, COUCH &
 ASSOCIATES, LLC.

- NOTES:**
- 1) PROPERTY BOUNDARY IS APPROXIMATE AS NOTED ON ABOVE REFERENCED TOPOGRAPHIC SURVEY.
 - 2) LOCATION OF PROPERTY WITHIN THE CONNECTICUT STATE PLANE NAD 1927 IS APPROXIMATE AND SHOULD NOT BE CONSIDERED ACCURATE.

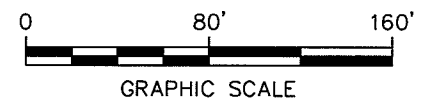

	21 Griffin Road North Windsor, CT 06095 (860) 298-9692
	CONNECTICUT RESOURCE RECOVERY AUTHORITY WATERBURY LANDFILL HIGHLAND AVENUE & HIGHVIEW STREET WATERBURY, CONNECTICUT
PROPOSED FINAL GRADING PLAN ALTERNATIVE #1	
Date: 04/05/07	Project No. 42798-0140-00000
Dwg: G2	

J:\CAD\42798\0140\Plate-1.dwg, G2 11x17, 4/5/2007 2:10:40 PM, Adobe PDF

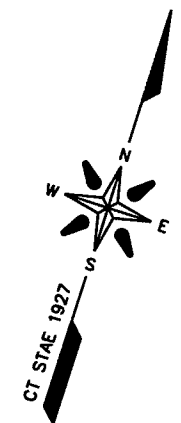
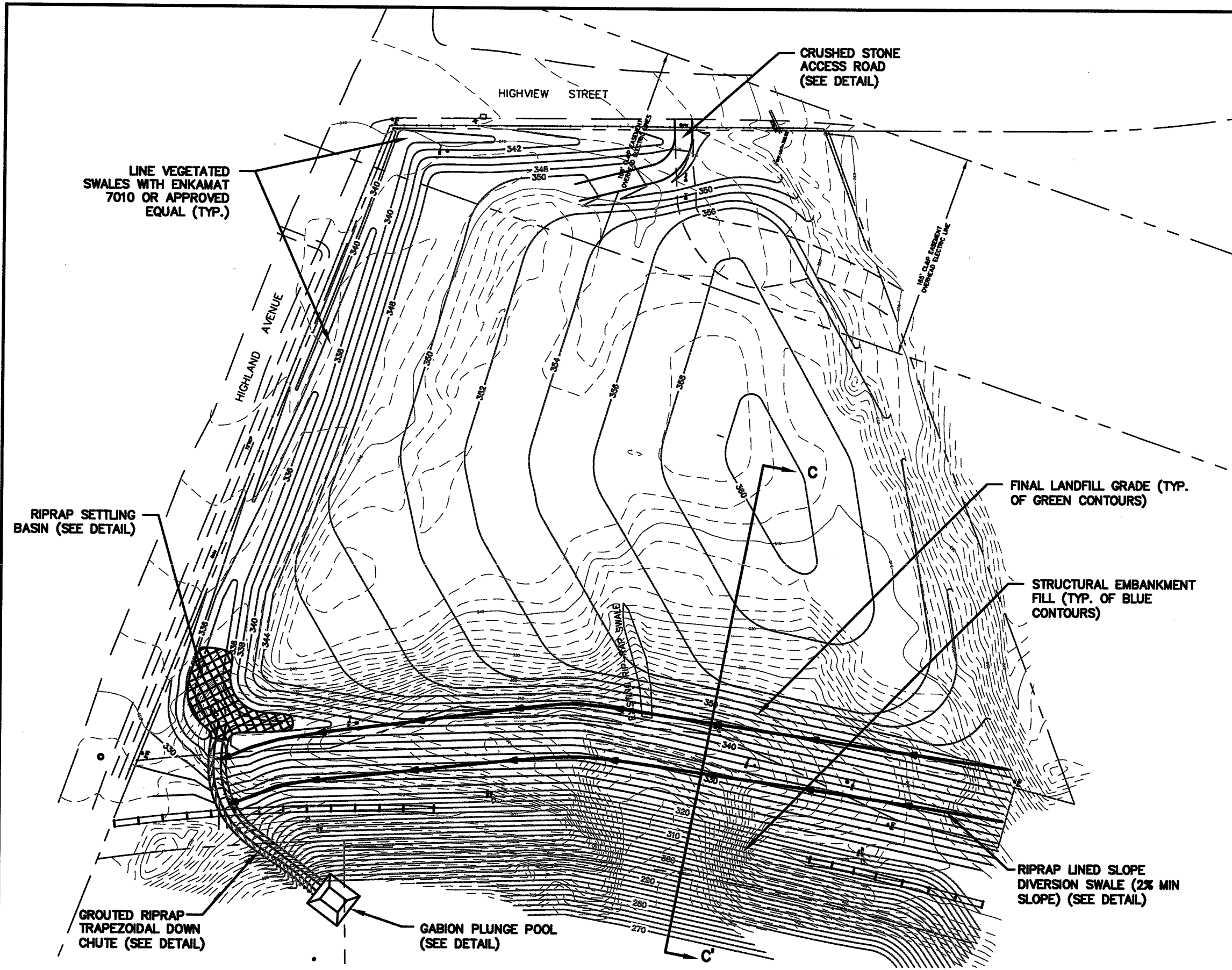

SOURCE:
 BASE MAP FROM TOPOGRAPHIC SURVEY
 TITLED "TOPOGRAPHIC SURVEY, WATERBURY
 LANDFILL, HIGHLAND AVENUE & HIGHLAND
 STREET, WATERBURY, CONNECTICUT,
 PREPARED FOR CONNECTICUT RESOURCE
 RECOVERY AUTHORITY", DRAWING NUMBER:
 26-350TP, SCALE: 1"=20', DATED:
 12-20-06, BY MARTINEZ, COUCH &
 ASSOCIATES, LLC.

- NOTES:**
- 1) PROPERTY BOUNDARY IS APPROXIMATE AS NOTED ON ABOVE REFERENCED TOPOGRAPHIC SURVEY.
 - 2) LOCATION OF PROPERTY WITHIN THE CONNECTICUT STATE PLANE NAD 1927 IS APPROXIMATE AND SHOULD NOT BE CONSIDERED ACCURATE.

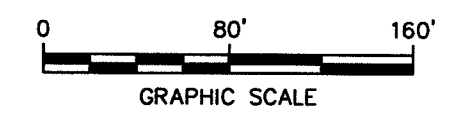

	21 Griffin Road North Windsor, CT 06095 (860) 298-9692
	CONNECTICUT RESOURCE RECOVERY AUTHORITY WATERBURY LANDFILL HIGHLAND AVENUE & HIGHVIEW STREET WATERBURY, CONNECTICUT
PROPOSED FINAL GRADING PLAN ALTERNATIVE #2	
Date: 04/05/07	Project No. 42798-0140-00000
Dwg: G4	

J:\CAD\42798\0140\Plate-1.dwg, G4 11x17, 4/5/2007 2:08:56 PM, Adobe PDF

J:\CAD\42798\0140\
 Plate-1.dwg Layout:G4 11x17 April 05, 2007-2:09PM KHOLLENBECK